

WOW II MAX

Channel Letter Solution

The WOW II MAX is highly efficient in power usage, capable of supporting 50ft with a 60W/12V power supply.



Specification Chart

Product Options	White (7500K/6300K/4200K/2700K)
Input Voltage	12VDC
Beam Angle	172°
Power consumption (watts)	0.8W/mod
LED / module	2
Modules / foot	1.5/ft. fully stretched
Lumen / module	160.2lm(7500K) ,155.39lm(6300k), 152.19lm(4200k),145.78lm(2700k)
Lumen / foot	240.3lm(7500K) ,233.09lm(6300k), 228.29lm(4200k),218.67lm(2700k)
Protection Grade	IP67
Operating Temp	-40°~ +60 °C / -40° ~ +140 °F
Storage Temp	-40°~ -70 °C / -40° ~ +158 °F
Cascade	25 mods single-ended power feed , 50 mods double-ended power feed
Packaging	70pcs/chain, 70pcs/bag, 10 bags/outer carton



- UV and IR Protected
- L80 rating of 50,000 hours
- Designed for medium to large Channel letters

Modules Population Guide

Channel Letter Depth (in)	Multiple Rows (rows spacing)	Clearance	Mods per Ft
3"	7"	4"	1.5
4"	10"	5"	1.5
5"- 6"	12"	6"	1.5
7"- 10"	15"-18"	7"	1.5

Dimensions & Viewing Angle

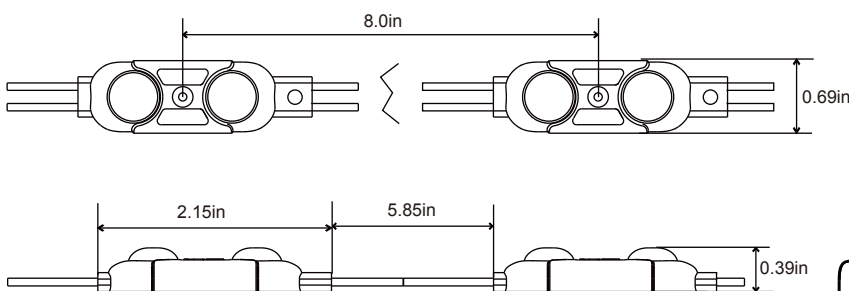

800.253.1569 | wensco.com

